

Angle seat valve VZXF-L-M22C-M-A-G12-120-M1-H3B1T-50-16

FESTO

Part number: 3535619

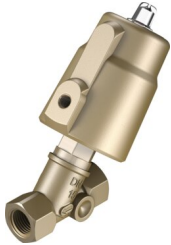

General operating condition

Data sheet

| Feature | Value |
|---------------------------------------|--|
| Design | Poppet valve with piston drive |
| Type of actuation | Pneumatic |
| Sealing principle | Soft |
| Mounting position | Any |
| Type of mounting | Inline installation |
| Line connection | Threaded coupling G1/2 to DIN ISO 228 |
| Nominal size | 12 mm |
| Valve function | 2/2-way, single solenoid, closed |
| Flow direction | Non-reversible |
| Medium pressure | 0 MPa ... 1.6 MPa |
| Medium pressure | 0 bar ... 16 bar |
| Nominal pressure PN | 16 |
| Exhaust-air function | Cannot be throttled |
| Type of reset | Mechanical spring |
| Type of piloting | Externally actuated |
| Pneumatic connection | Female thread G1/8 |
| Operating pressure | 0.6 MPa ... 1 MPa |
| Operating pressure | 6 bar ... 10 bar |
| Operating pressure | 87 psi ... 145 psi |
| Symbol | 00991367 |
| Medium | Vapour Inert gases Filtered compressed air, grade of filtration 200 µm |
| Direction of flow | Above valve seat, for gaseous media |
| Operating medium | Compressed air to ISO 8573-1:2010 [7:4:4] |
| Max. viscosity | 600 mm ² /s |
| Media temperature | -40 °C ... 200 °C |
| Ambient temperature | -10 °C ... 60 °C |
| Flow rate Kv | 3.5 m ³ /h |
| Note on materials | RoHS compliant |
| LABS (PWIS) conformity | VDMA24364 zone III |
| Material process valve housing | Red brass |
| Material number process valve housing | CC499K |
| Material spindle seal | PTFE |
| Material seat seal | PTFE |
| Product weight | 1200 g |

| Feature | Value |
|--------------------------------|--------------------------|
| Corrosion resistance class CRC | 1 - Low corrosion stress |
| Material drive housing | Brass |